

XVI

ENHANCED CVI
MegaPixel over UTP/Coax

NightPixel
COLOR
Low Light Enhancement



Full Color



XVI-50NPCBFT



XVI 5MP Night Pixel
Full-Color Turret Camera

Features:



- Max 25 fps@5MP (True 16:9 video output)
- 120 dB true WDR, 3D NR
- 24/7 color imaging
- 1CH Built-in mic (-A)
- 40m/131.2ft illumination distance
- CVI/CVBS/AHD/TVI switchable
- 2.8 mm fixed lens
- IP67, 12 V DC



FREE Multisite VMS software
Download from www.watchnetinc.com

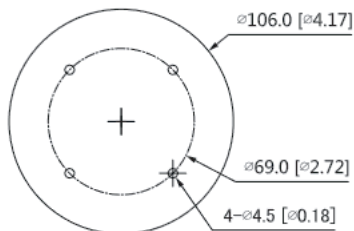
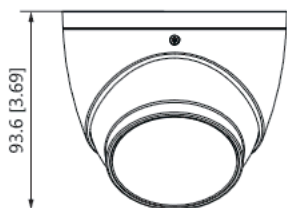

Optional Brackets



BRACK-PM-06
Ceiling Mount



BRACK-BB-43
Junction Back Box



BRACK-WM-49
Wall Mount

Model	XVI-50NPCBFT
Camera	
Image Sensor	5 Megapixel progressive scan CMOS
Effective Pixels	2880 (H) × 1620 (V)
Min. Illumination	0.001 Lux/F1.0, 0 Lux warm light on
S/N Ratio	More than 65dB
Scanning System	Progressive
Electronic Shutter Speed	PAL:1/3 s–1/100,000 s NTSC:1/4 s–1/100,000 s
Illuminator On/Off Control	Auto; manual
Illumination Distance	40m (131.2ft)
Illuminator Number	2
Lens	
Lens Type	Fixed-focal
Focal Length	2.8 mm
Max. Aperture	F1.0
Mount Type	M12
Angle of View	132° × 111° × 58° (diagonal × horizontal × vertical)
Iris Type	Fixed iris
Close Focus Distance	1.6m (5.25ft)
Video	
Resolution	5M (2880 × 1620); 4M (2560 × 1440); 1080p (1920 × 1080); 960H (960 × 576/960 × 480)
Frame Rate	CVI: PAL: 5M@25 fps; 4M@25 fps; 1080p@25 fps NTSC: 5M@25 fps; 4M@30 fps; 1080p@30 fps AHD: PAL: 4M@25 fps; NTSC: 4M@30 fps TVI: PAL: 4M@25 fps; NTSC: 4M@30 fps CVBS: PAL: 960H; NTSC: 960H
Smart Light	Yes
BLC Mode	BLC/HLC/WDR/HLC-Pro
WDR	120 dB
Gain Control	Auto / Manual
Noise Reduction	3D NR
White Balance	Auto; Area WB
Mirror	Off/On
Privacy Masking	Off/On (8 areas, rectangle)

DORI	Detect	Observe	Recognize	Identify
Distance	67.4m (212.3ft)	27.0m (88.6ft)	13.5m (44.3ft)	6.7m (22.0ft)
2.8mm Lens				
Port				
Video Output	Video output choices of CVI/TVI/AHD/CVBS by one BNC port			
Audio Input	1CH Built-in MIC (-A)			
Power				
Power Supply	12 V ±30% DC			
Power Consumption	Max 6.4 W (12 V DC, warm light on)			
Environmental				
Operating Conditions	–40°C to +60°C (–40°F to 140°F) < 95% (non-condensation)			
Storage Conditions	–40°C to +60°C (–40°F to 140°F) < 95% (non-condensation)			
Protection Grade	IP67			
Construction				
Casing	Metal throughout the whole casing			
Dimensions	φ106.0 mm × 93.6 mm (φ4.17" × 3.69")			
Net Weight	0.48 Kg (1.06 lb)			
Gross Weight	0.67 Kg (1.48 lb)			

All logos & trade marks represent the registered users only. All rights reserved.
All product specifications on this brochure are subject to change without notice.

CANADA:
351 Ferrier Street, Unit 5
Markham, ON L3R 5Z2
Toll Free: 1-866-843-6865
Tel: 416-410-6865

USA:
171 Cooper Ave. Suite 110
Tonawanda, NY 14150 USA
Toll Free: 1-866-843-6865
Local: 1-716-877-7277

UAE:
PO Box 126312
No 703, Oxford Towers
Business Bay, Dubai, UAE
Tel: +971 4 2767117

SMarch 21, 2021

info@watchnetinc.com
www.watchnetinc.com