

BLS-50IRBFT28-B

5MP IR Fixed Turret Network Camera



NDA
Compliant



Features:

- 1/2.8" progressive scan CMOS
- 2.8mm fixed lens
- True WDR, 3D DNR, ROI, HLC, BLC, Defog
- 2.8mm focal length
- Built-in 1 channel microphone
- Smart IR up to 30m/98.4ft
- Built-in micro SD slot, up to 256GB
- IP66, PoE

Smart Function:

- Supports face, human, vehicle detection and capture

Intelligent Detection:

- Fenced area
- Single virtual fence
- Double virtual fences
- Loitering
- People counting

Dimensions (mm)

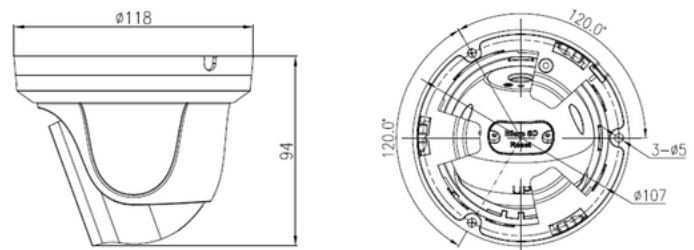

Optional Accessories:



BLS-BB-46B
Back Box



Note: WatchNET NDA Network Video Recorders work only with Blue Series Cameras

Specifications

Camera	
Image Sensor	1/2.8" Progressive Scan CMOS
Max. Resolution	5MP (2592×1944)
Electronic Shutter	Auto/Manual, 1/5 ~ 1/20,000s
Min. illumination	Color: 0.03 Lux @ (F1.6, AGC ON), B/W: 0 Lux @ (IR LED ON)
Day & Night	IR cut filter
IR Distance	Up to 30 m (98.4 ft)
IR On/Off Control	Auto/Manual
Pan/Tilt/Rotation Range	Pan: 0° ~ 355°, Tilt: 0° ~ 80°, Rotation: 0° ~ 360°
Lens	
Lens Type	Fixed
Iris	Fixed Iris
Focal Length	2.8 mm (4 mm optional)
F Number	F2.0
Angle of View	H: 93.4°, V: 69.1
Video	
Streaming Capability	2 Streams
Stream/Frame Rate	Stream1: 2592×1944, 2592×1520, 1920×1080 1280×720 @ 25/30fps Stream2: D1, VGA, CIF @ 25/30fps Stream3: VGA, CIF, QVGA @ 25/30fps
Bit Rate Control	CBR/VBR
Bit Rate	Stream1: 200kbps~12Mbps Stream2: 100kbps~6Mbps Stream3: 100kbps~3Mbps
Smart Encoder	Support
Region of Interest (ROI)	Off/On (8 Zone, Rectangle)
Audio	
Compression	G.711:8kbps
Bit Rate	16kbps (G.711)
Smart Function	
Smart Detection	Support human and vehicle detection
Smart Events	Intrusion, Single line crossing, Double line crossing, Loitering, Wrong way, People counting Support alarm triggering by specified target types (human and vehicle)
Interface	
Network Interface	1 Ethernet (10/100 Base-T) RJ-45 Connector
Audio Interface	1ch Input, 1ch Output
Built-in Microphone	yes
Alarm Interface	1ch Input, 1ch Output
SD Card Slot	Built-in, up to 256GB
Reset Button	Support

Image	
Image Adjustment	Brightness, Sharpness, Contrast, Saturation adjustable
Aisle Mode	Support
Mirror	Support
White Balance	Auto/Manual
Day/ Night Setting	Auto, Day, Night, Time
Smart IR	Support
Noise Reduction	2D/3D DNR
Image Enhancement	HLC, BLC, Defog
Wide Dynamic Range	True WDR
S/N Ratio	55dB
Motion Detection	Support
Privacy Masking	Support
Network	
Protocols	IPv4/IPv6, 802.1x, HTTP, HTTPS, TCP/IP, UDP/IP, RTSP, DHCP, NTP, RTPC/RTP, PPPoE, SMTP, DNS, UPnP, FTP, ARP, SNMP, TLS/SSL
Interoperability	ONVIF, SDK, CGI
Streaming Method	Unicast
Max. User Access	10 Users
Web Viewer	<IE11, Chrome, Firefox
Language	English, Chinese, Polish, Italian, Portuguese, Spanish, Russian, French, Czech, Hungarian. Default: English
Electrical	
Power Supply	DC12V (-15%~+20%)/POE (IEEE 802.3af)
Power Consumption	Max 6 W
Operating Temperature	-40°C ~ 55°C (-40°F ~ 131°F)
Operating Humidity	Less than 90% RH
Ingress Protection	IP66
Certifications	CE/FCC
Casing	Metal + Plastic
Dimensions	φ118×94 mm (4.65×3.7 inch)
Net Weight	0.55 kg (1.21 lb)

* All product names, logos and brands are property of their respective owners. All company products and service names used on this brochure are for identification purposes only. Use of these names, logos and brands does not imply endorsement. 2022 WatchNET Inc. © All Rights Reserved
All product specifications are subject to change without notice.

CANADA:
351 Ferrier Street, Unit 5
Markham, Ontario L3R 5Z2
Canada
Tel: 416-410-6865
Toll Free: 1-866-843-6865

USA:
171 Cooper Ave.
Suite 110, Tonawanda
New York 14150, USA
Tel: 1-716-877-7277
Toll Free: 1-866-843-6865

MIDDLE EAST:
PO Box No 126312
Office Suite 703, Oxford
Tower Business Bay, Dubai,
UAE
Tel: + 971 4 2767117

March 2024

www.watchnetinc.com
info@watchnetinc.com